

P5000

DF GR PI PG

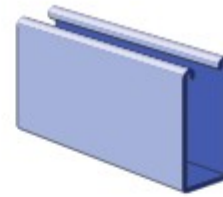
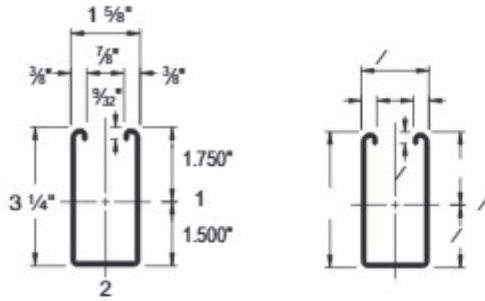

Wt/100 Ft: 305 Lbs (454 kg/100 m)
 Allowable Moment 15,770 In-Lbs (1,780 N-m)
 12 Gauge Nominal Thickness .105" (2.7mm)

P5001

DF GR PG

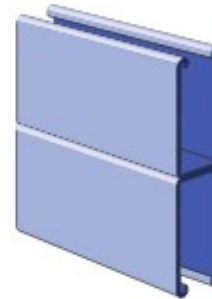
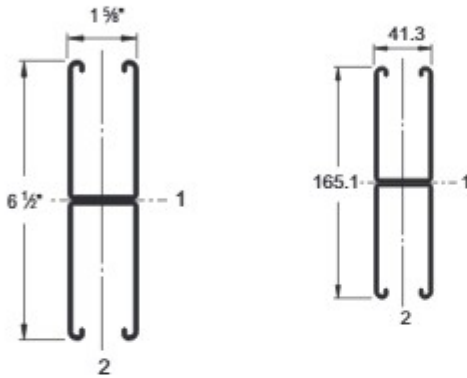

Wt/100 Ft: 610 Lbs (907 kg/100 m)
 Allowable Moment 48,180 In-Lbs (5,440 N-m)
 12 Gauge Nominal Thickness .105" (2.7mm)

P5000 HS

GR PG

3/8" (14.3) Dia. Holes
 1 1/8" (47.6) on Center

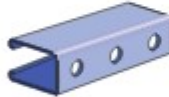

Wt/100 Ft: 300 Lbs (446 kg/100 m)

P5000 KO

GR PG

1/8" (22.2) Knockouts
 6" (152.4) on Center



Wt/100 Ft: 305 Lbs (454 kg/100 m)

P5000 SL

GR PG

Slots are
 3" (76.2) x 1 1/2" (10.3)
 4" (101.6) on Center

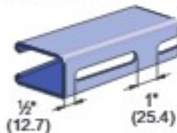

Wt/100 Ft: 300 Lbs (446 kg/100 m)

P5000 T

DF GR PG

Slots are
 1 1/8" (28.6) x 3/8" (14.3)
 2" (50.8) on Center

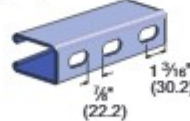

Wt/100 Ft: 300 Lbs (446 kg/100 m)

P5000 WT

DF GR HG PG PI

Slots are
 2" (50.8) x 1 1/8" (17.5)
 3" (76.2) on Center

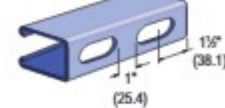

Wt/100 Ft: 300 Lbs (446 kg/100 m)

CHANNEL NUTS



P5506-0832
 P5506-1024
 P5506-1420
 P5507
 P5508
 P5509
 P5510



P1006T1420
 P1008T
 P1010T



P1012
 P1023
 P1024



P3006-0832
 P3006-1024
 P3006-1420
 P3007
 P3008
 P3009
 P3010



P3016-0632
 P3016-0832
 P3016-1024
 P3016-1420

Channel Finishes: DF, PL, GR, HG, PG, ZD; Standard Lengths: 10' & 20'

1 1/4" System
 Telestrut
 Nuts & Hardware
 General Fittings
 Pipe/Conduit Support
 Concrete Inserts
 Solar
 1 1/4" System
 1 1/4" System
 Special Metals